



# Abhi's PRAGATHI SQUARE



**COME HOME TO LUXURY**

EXPLORE A MAGNUM OPUS DESIGNED JUST FOR YOU



**2 & 3 BHK**  
**Luxury Turnkey Apartments**  
(Gated Community Features)  
**@ Pragathi Nagar**



# Abhi's PRAGATHI SQUARE

CONVENIENTLY  
CLOSE TO EVERYWHERE

Let your home do the talking. You do the walking. Your home makes a statement while you live the good life. Live in the vicinity of life where every thing is right next to you.

Few minutes to reach all Popular Shopping Malls, Schools IT Corridors, Hospitals, Restaurants, Metro / Bus Stations & Highways ...







# AMENITIES & FEATURES

## › Luxurious Fully Furnished Flats:

Complete Wood Work & False Ceilings  
Automatic Door Lock  
Video Door Phone  
Geyser in all Bathrooms  
Split AC Provisioning in Living and all Bedrooms  
Tiles around the Main Door  
Energy efficient LED Lights, Grills, Fans, Wash Basins/Sinks  
Showers, Mirrors etc

## › 24x7 Municipal Water

Ample quantity for flat with common Water Softener

## › 24x7 Power Backup

Common areas and all Fans & Lights in each flat

## › Fully furnished Multi-Purpose Hall

Stage, Changing Rooms, Separate Toilets

## › Featured Indoor Games Room

Shuttle Court, Table Tennis, Carroms, Chess etc.

## › Well Equipped Gym / Fitness center

## › Intercom for all flats

## › CCTV Surveillance for safety & security

## › Featured Play / Recreational Areas for Kids

## › Solar Fencing for security

## › Drip / Sprinkler Irrigation for Landscaping

## › Separate Water & Electric Meters

## › Staircases with SS steel railing

## › Spacious Balconies and Corridors

## › Covered Parking

1 Car Parking and 1 Two Wheeler Parking

## › Common Amenities

Fully Automated 2 Lifts  
High Capacity Generator  
Full Capacity Transformer  
All Equipments are Automated

## › Rain Water Harvesting

## › 2 Watchman Rooms with facilities for Drivers

## › 4 Lavish Entrance & Exit Gates for Easy In & Out



# TYPICAL FLOOR PLAN



60'-0" WIDE NORTH SIDE ROAD

30'-0" WIDE WEST SIDE ROAD

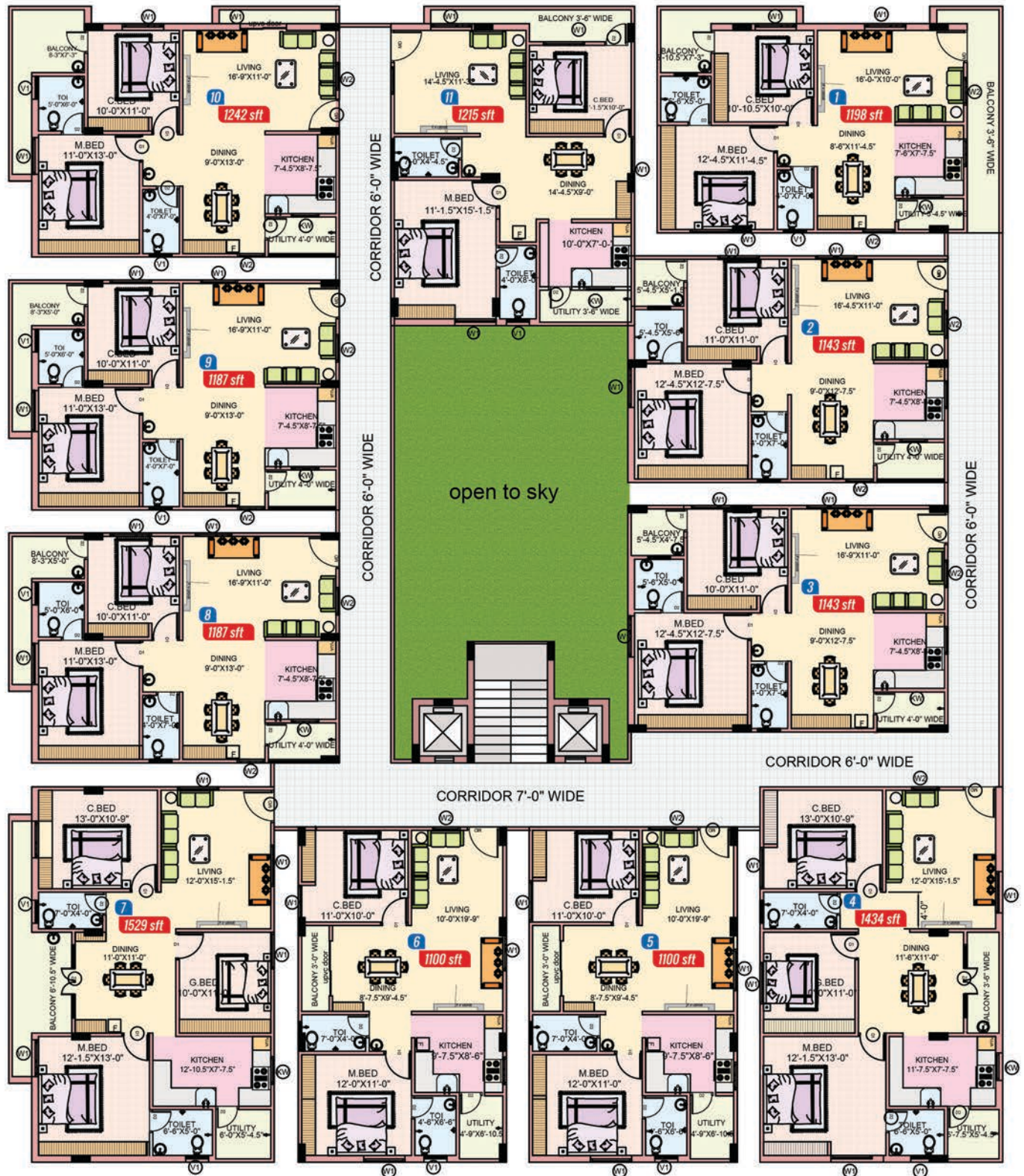

Level up the Luxury to  
Complement your Stature

## AREA STATEMENT

Flat No	SFT	Flat No	SFT
1	1198	7	1529
2, 3	1143	8, 9	1187
4	1434	10	1242
5, 6	1100	11	1215



CHOOSE THE HOME OF  
**YOUR DREAMS**

*Abhi's*  
**PRAGATHI SQUARE**



### ABHI'S PRAGATHI SQUARE IS A LANDMARK FOR IT PROFESSIONALS

With all the modern features of a gated-community living with style, luxury and quality.  
A close to everything location, with everything furnished and ready to move in -  
**A PERFECT FINAL DESTINATION !!!**

### LOCATION HIGHLIGHTS



Just 3 km from JNTU &  
Metro/Bus Stations



ORR is  
Just 5km away



Only 7 km  
to Hitech City



Popular Hospitals  
within 5 km radius



Just 3 km to Schools  
Oakridge, DPS, Ambitus



5 km to Manjeera &  
Forum Shopping malls



## AMPLE PARKING

1 Car and 1 Two-wheeler parkings, 4 easy and convenient entry & exit gates, and off-street parking for guests on a cul-de-sac 60' road.

Abhi's  
PRAGATHI SQUARE

60'-0" WIDE NORTH SIDE ROAD





PARKING PLAN











# SPECIFICATIONS

	<b>STRUCTURE</b>	Reinforced Cement Concrete (RCC) framed structure.
	<b>WALLS</b>	Red brick masonry in cement mortar.
	<b>PLASTERING</b>	Double coat plastering with sponge finish.
	<b>DOORS</b>	Main door frame with premium Teakwood and designed door shutters & internal doors with Teakwood frames and flush shutters or UPVC Doors
	<b>WINDOWS</b>	Premium UPVC windows with Mosquito Mesh and safety iron grills.
	<b>FLOORING</b>	Reputed brand 2x2 Vitrified tiles for all rooms and balconies. Staircases and Corridors with premium granite with 5" skirting.
	<b>KITCHEN</b>	Premium granite slab for kitchen platform with stainless steel sink, ceramic dado until window top over the kitchen platform. Exhaust fan and kitchen drawers.
	<b>WATER SUPPLY</b>	24x7 Muncipal water and Borewell water from overhead separate tanks.



	<b>ELECTRICAL FITTING</b>	Legrand/ other reputed brand switches, multi-core wires with adequate light, fan, fridge, geyser points. Provision for TV, Telephone and Internet.
	<b>PAINTS</b>	Lappam finish and emulsion paints for inner walls and ceiling. Asian exterior paints and Enamel paints for doors and grills.
	<b>BATHROOM</b>	Cera/ other reputed brand sanitaryware. Two Western/ Indian style commodes, corner washbasin, mirror, towel holders and shower shelve. Designer ceramic tiles upto ceiling on walls.
	<b>LIFT</b>	6 Passenger capacity automated lifts
	<b>PARKING AREA</b>	Parking tiles for complete stilt floor.
	<b>AMENITIES</b>	Car parking, High capacity Generator, Electric Transformer, Automated Lifts, Water softner and all other <b>Listed Amenities &amp; Features.</b>
	<b>EXTRAS</b>	VAT, Service Tax and Registration charges will be bourne by the buyer.







## PREVIOUS PROJECTS



**PRAGATHI SQUARE**  
Survey No. 165  
Next to INCOIS Quarters  
Pragathi Nagar,  
Hyderabad - 500090

**ABHI CONSTRUCTIONS**  
Villa 247, Hill County  
Nizampet Road,  
Bachupally,  
Hyderabad - 500090



970 461 9754  
957 366 3536



contact@abhiconstructions.in



www.abhiconstructions.in

## Project Approved Banks



This brochure is only a conceptual representation of the project and not a legal offering. Abhi Constructions reserves the right to make changes in elevation, specifications and plans without prior notice, in the interests of quality and timely delivery. we request our valuable customers to note that any such changes made will not, in any way, be detrimental to the quality of the building.